

clarisonic



FIT Series

EN

Fit Series
User Guide

ALPHA FIT

BRUSH HEAD

A

ON/OFF BUTTON

B

SPEED SETTING
INDICATOR

D

USB ENABLED
CHARGER

F

clarisonic

C

SPEED SETTING
SELECTION

E

BATTERY LIFE
INDICATOR

G

PROTECTIVE CAP

AC ADAPTER
(NOT SHOWN)

Available with
some models



Mia FIT

BRUSH HEAD

A

ON/OFF BUTTON

B

SPEED SETTING
INDICATOR

D

USB ENABLED
CHARGER

F



clarisonic

C

SPEED SETTING
SELECTION

E

BATTERY LIFE
INDICATOR

**AC ADAPTER
(NOT SHOWN)**
Available with
some models

IMPORTANT SAFEGUARDS

When using electrical products, especially when children are present, basic safety precautions should always be followed, including but not limited to the following:

READ ALL INSTRUCTIONS BEFORE USE

DANGER – To reduce the risk of electrocution:

1. **Do not** place or store the charger or adapter where it can fall or be pulled into a bathtub or sink.
2. **Do not** place the charger in or drop the charger or adapter into water or other liquid. Charger unit is not for immersion or for use in the shower.
3. **Do not** reach for a charger or adapter that has fallen into water.
Unplug immediately.

WARNING – To reduce the risk of burns, electrocution, fire, or injury to persons:

1. Close supervision is necessary when this product is used by, on, or near children or physically challenged persons.

2. This product is for use in home, spas, salons and similar locations. Use this product only for its intended use as described in this manual.
3. Keep the cord away from heated surfaces.
4. **Do not** use the charger outdoors.
5. Use only the adapter and accessories supplied by the manufacturer.
6. Never operate the Clarisonic device if it is damaged. **Do not** operate the charger if it has a damaged cord or adapter, if it is not working properly, if it has been dropped or damaged, or dropped into water.

SAVE THESE INSTRUCTIONS

- The device, charger and power adapter have no serviceable parts.
- The supply cord cannot be replaced. If the cord is damaged, the charger must be unplugged and replaced.

NOTE: This equipment has been tested and found to comply with the limits for a Class B digital device, pursuant to part 15 and part 18 of the FCC (Federal Communications Commission) Rules. This equipment complies with Canadian standards ICES-001 and ICES-003e.

IMPORTANT CAUTIONS AND WARNINGS

- If you are under a doctor's care for any skin condition or if you think you may have a skin condition, please consult your physician before using the Clarisonic device.
- We recommend that you **do not** share brush heads.
- **Do not** use the Clarisonic device with jagged exfoliating particles such as shells.
- Using the Clarisonic device to remove makeup may stain the bristles, but will not affect performance. If discoloration occurs, clean the brush head with soap and water.
- This product uses magnets.

Treatment of electrical and electronic equipment applicable at the end of life in the European Union and other European countries with selective collection systems:

This product should not be treated as household waste but should be handled at a designated collection point for the recycling of electrical and electronic equipment. Please contact your local authority for further details of your nearest designated collection point.

CHARGING

Your device is rechargeable with the included charging base. A fully charged device provides approximately 28 minutes of use depending on the setting at which it is run. The convenient USB-enabled charger is provided to recharge the device using either a traditional wall mount AC adapter or computer USB port.

Charging Indicators

Action	Indicator
Place device on charger	Device emits two pulses.
Charge the device	The battery life indicator will flash from red to green as it charges.
When fully charged	Battery life indicator glows solid green. Allow 18 hours for a full charge.



The charger is compatible with 100–240 Volts AC; 50/60 Hz, allowing it to be used worldwide with the appropriate country adapter. If the shape of the plug does not fit the power outlet, use an attachment plug adapter of the proper configuration for the power outlet.

NOTE:

- This device is not compatible with other Clarisonic charger models.
- Do not use charger on metal surfaces, as it will interfere with proper device charging.

CARING FOR YOUR DEVICE

To keep your Clarisonic device in optimum condition, care for it as follows:

Do not use abrasive cleansers or chemicals to clean any part of the Clarisonic device.

Do not put any part of the Clarisonic device in the dishwasher.

DEVICE

Once a week remove the brush head and wash the device using warm soapy water to remove any residue buildup. The device is sealed and fully waterproof. Never attempt to open the device for any reason.

USB CHARGER

IMPORTANT: Unplug the USB charger, then wipe it with a soft, damp cloth. Do not immerse the charger in water.

STORAGE

If you are not using the device for long periods of time (weeks/months), unplug the charger, clean the brush head and device, and store it in a cool dry place away from direct sunlight.

INFREQUENT USE: The device should receive a charge occasionally. If you rarely use the device, charge it with the supplied charger and wall power supply every 6 months to maintain its charging capability.

Device Disposal at End of Product Life: Your Clarisonic device is sealed and contains rechargeable NiMH batteries. These batteries are non-replaceable and the sealed device is non-repairable. When your device reaches end of life: it no longer holds a charge, does not function and is out of warranty; this device must be recycled or disposed of per your local regulations. Do not dispose of it in fire.

BRUSH HEADS

Brush heads need to be replaced every 3 months as the bristles become fatigued and less effective over time. Once a week, remove the brush head from the device and rinse with warm soapy water to remove any residue.

- **To remove the brush head:** 1) Grip the brush head firmly, then push and twist it counter-clockwise; 2) Pull the head away from the device.
- **To attach the brush head:** Push down and twist the brush head clockwise until it snaps into place. Be sure you hear a tight snap.

Tip: Use the brush head cap to easily remove and attach the brush head with a simple twist.

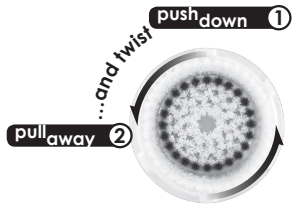

CLARISONIC CUSTOMER SERVICE INFORMATION

USA:

For general inquiries please contact Clarisonic Customer Service by telephone 888-525-2747 or visit our website www.clarisonic.com.

To take advantage of our warranty and get the most efficient service from our Customer Care, register your device at www.clarisonic.com/registration. Benefit from special offers when you register!

90 DAY FEEL AND SEE GUARANTEE

We are happy to offer a 90 day money back guarantee. If you are for any reason dissatisfied with the purchase of your device from an authorized dealer, contact our customer service team by telephone 888-525-2747 to make arrangements for the return.

Disclaimer: The 90 day Feel and See Guarantee does not apply to Clarisonic devices purchased in the travel retail channel.

Canada:

For general inquiries please contact Clarisonic Canada by telephone 1-866-459-1860 or visit our website www.clarisonic.ca.

To take advantage of our warranty and get the most efficient service from our Customer Care, register your device at www.clarisonic.ca. Benefit from special offers when you register!

90 DAY FEEL AND SEE GUARANTEE

We are happy to offer a 90 day money back guarantee. If you are for any reason dissatisfied with the purchase of your device from an authorized dealer, contact our customer service team by telephone 1-866-459-1860 to make arrangements for the return.

Disclaimer: The 90 day Feel and See Guarantee does not apply to Clarisonic devices purchased in the travel retail channel.

CLARISONIC CUSTOMER SERVICE INFORMATION

For general inquiries please visit our website clarisonic.com/customerservice or contact your in-country customer service team.

Australia:

Clarisonic is a part of the Luxe Division of L'Oréal Australia Pty Ltd.

For general customer service inquiries, please visit www.clarisonic.com.au, contact Consumer Affairs by telephone 1300 820 430 or email luxuryproductsadvisory@au.loreal.com.

Australia - 90-DAY "FEEL AND SEE" MONEY BACK GUARANTEE:

Clarisonic is pleased to provide its customers with a 90 day "Feel and See" Money Back Guarantee Offer for all of its devices. Please refer to www.clarisonic.com.au for full Terms & Conditions.

Disclaimer: The 90 day Feel and See Guarantee does not apply to Clarisonic devices purchased in the travel retail channel.

② CLARISONIC LIMITED WARRANTY

**For the conditions of your Limited Warranty, we refer you to the following:
United States & Canada:**

1. Warranty Coverage

- a) For the duration of the Warranty Period, Clarisonic warrants the Product against defects in materials and workmanship arising from Normal Use of the Product.
- b) If there is a defect in the Product which is covered by this Limited Warranty, Clarisonic agrees to replace the Product with a new equivalent Product. This is the sole remedy available for breach of Warranty. Should you wish to return the Product for exchange, you must contact customer services (see Clarisonic Customer Service information section).
- c) This Limited Warranty is exclusive of all other Warranties, whether oral or written, expressed or implied. There are no implied Warranties created by the manufacture, sale, or use of the Product. If Clarisonic cannot lawfully disclaim implied Warranties under this Limited Warranty, all such Warranties, including Warranty of merchantability and fitness for a particular purpose, are limited in duration of this Limited Warranty. Some states and provinces do not allow limitations on how long an implied Warranty lasts, so this limitation may not apply to you.

2. How to get Warranty service

Subject to the limitations listed below you may obtain service under this Limited Warranty by contacting our customer service center by telephone or visit our website. Refer to Clarisonic Customer Service Information section for specific country contact information.

3. Limitations

- a) This Warranty is limited and may be relied upon only:
 - (i) by the original end user of Clarisonic's Product; and
 - (ii) where the Product was manufactured by or for Clarisonic and sold by an authorized distributor.
- b) To obtain service under this Limited Warranty, you will be required to provide Clarisonic with original proof of purchase date.
- c) This Limited Warranty does not apply where the Product is subjected to use that does not constitute Normal Use, including but not limited to personal injury or property damage arising from misuse of the Product.

4. Exclusions

Clarisonic is not responsible for any indirect, incidental, special or consequential damages arising out of the use of the Product, whether arising from an electrical issue or otherwise;

except as determined by law. Some US States do not allow the exclusion or limitation of incidental or consequential damages, so the above limitation or exclusion may not apply to you.

5. Validity

This Limited Warranty is valid only in the US and Canada, as defined by US and Canadian law and this present Warranty.

6. Definitions

- a) "**Normal Use**" means ordinary consumer use under normal home conditions according to the instruction manual included with the Product. It does not include using the Product with a voltage converter.
- b) "**Product**" means **Alpha Fit** or **Mia Fit**.
- c) "**Warranty Period**" means **2 years** from the date of purchase of the Product, as indicated on the original proof of purchase.

② CLARISONIC LIMITED WARRANTY

United Kingdom and Republic of Ireland:

1. Warranty Coverage

- a) For the duration of the Warranty Period, Clarisonic warrants the Product against defects in materials and workmanship arising from Normal Use of the Product.
- b) If there is a defect in the Product which is covered by this Warranty, Clarisonic agrees to exchange the Product with a new equivalent Product. Clarisonic's sole obligation under this Warranty is limited to such replacement. The Warranty is an added benefit which does not affect the consumer's statutory rights.

2. How to get Warranty Service

Subject to the limitations listed below, you may obtain service under this Warranty by contacting our customer services by telephone 0800 783 3975, or writing to Customer Services, Clarisonic, a division of L'Oréal (U.K.) Limited, 255 Hammersmith Road, London W6 8AZ.

3. Conditions and Exclusions

- a) This Warranty is limited and may be relied upon only:
 - (i) by an end user of the Clarisonic Product;
 - (ii) within the Warranty Period;

- (iii) for Products purchased in the United Kingdom and Republic of Ireland; and
 - (iv) where the Product was manufactured by or for Clarisonic and sold by an authorised distributor.
- b) To obtain service under this Warranty, you will be required to provide Clarisonic with original proof of purchase.
 - c) Clarisonic shall not be obliged to repair or replace any Product which is not accompanied by a valid proof of purchase.
 - d) This Warranty does not apply where the Product is subjected to use that does not constitute Normal Use or to unauthorised repair.

4. Exclusions

Clarisonic is not responsible for any indirect, incidental or consequential damages arising out of the use of the Product, whether arising from an electrical issue or otherwise, except as required by law.

5. Definitions

- a) **“Normal Use”** means ordinary consumer use under normal home conditions and used in accordance with the instruction manual included with the Product. It does not include use of the Product with a voltage converter, use on current or voltage other than as advised on the charger, negligent use or misuse.
- b) **“Product”** means Clarisonic **Alpha Fit** or **Mia Fit**.

- c) **“Warranty Period”** means **2 years** from the date of purchase of the Product, as indicated on the original proof of purchase.

6. Consumer Statutory Rights

This Warranty gives specific legal rights and does not affect the statutory rights a consumer may have or those rights that cannot be excluded or limited, nor rights against the retailer from which the consumer purchased the Product. The consumer may assert any such rights at his or her sole discretion. Consumers can obtain information about their legal rights from trading standards offices or citizens' advice bureaux.

7. Governing Law and Jurisdiction

This Warranty and any dispute or claim arising out of or in connection with it or its subject matter or formation (including non-contractual disputes or claims) shall be governed by and construed in accordance with the laws of England and Wales. The courts of England and Wales shall have exclusive jurisdiction to settle any dispute or claim that arises out of or in connection with this Warranty or its subject matter or formation (including non-contractual disputes or claims).

For further information on how to obtain service under this Warranty, contact our Customer Service department by telephone 0800 783 3975, write to Customer Services, Clarisonic, a division of L'Oréal (U.K.) Limited, 255 Hammersmith Road, London W6 8AZ or visit www.clarisonic.co.uk.

Hong Kong:

The following Warranty is limited to and applies to all purchases made in Hong Kong.

1. Definitions

- a) "**Normal Use**" means ordinary consumer use under normal home conditions according to the instruction manual included with the Product. Normal use does not include using the Product with a voltage converter.
- b) "**Product**" means **Alpha Fit** or **Mia Fit**.
- c) "**Warranty Period**" means **2 years** from the date of purchase of the Product.

2. Warranty Coverage

- a) For the duration of the Warranty Period, Clarisonic warrants the Product against defects in materials and workmanship arising from Normal Use of the Product.
- b) If there is a defect in the Product which is covered by this Limited Warranty, Clarisonic agrees to exchange the Product with a new equivalent Product. This is the sole remedy available for breach of Warranty.
- c) This Warranty excludes all other Warranties, whether oral or written, expressed or implied. There are no implied Warranties created by the manufacture, sale, or use of the Product.

3. How to get Warranty service

Please contact your local customer services office by telephone (852) 3180-1645 or visit our website www.clarisonic.com.hk for further information.

4. Limitations

- a) This Warranty is limited and may be relied upon only:
 - (i) by the original end user of Clarisonic's Product; and
 - (ii) Where the Product was manufactured by or for Clarisonic and sold by an authorized distributor.
- b) To obtain service under this Warranty, you will be required to provide Clarisonic with original proof of purchase.
- c) This Warranty does not apply where the Product is subjected to use that does not constitute Normal Use, including but not limited to personal injury or property damage arising from misuse of the Product.

5. Exclusions

Clarisonic is not responsible for any indirect, incidental, special or consequential damages arising out of the use of the Product, whether arising from an electrical issue or otherwise.

6. Validity

This Warranty is valid only in respect of purchases made with authorized distributors and all disputes arising from the purchase of the Product or the interpretation of this Warranty shall be governed by Hong Kong law.

For further information about Warranty service or general customer service inquiries, please visit www.clarisonic.com.hk or contact our customer service hotline (852) 3180-1645.

Hong Kong – 30 day Feel and See Guarantee disclaimer:

We offer a 30 day money back guarantee. The Feel and See Guarantee is valid for a period of 30 days from date of purchase and can only be claimed from the retailer where the device was originally purchased. Proof of purchase is required and the product must be returned in its original packaging with all the components.

PLEASE NOTE: The 30 day Feel and See Guarantee does not apply to Clarisonic devices purchased in the travel retail channel.

Remarks: The Chinese version of this statement is provided for reference only. In the event of any inconsistency between the Chinese and English versions, the English version shall prevail.

Singapore:

1. Warranty Coverage

- a) For the duration of the Warranty Period, Clarisonic warrants the Product against defects in materials and workmanship arising from Normal Use of the Product.
- b) If there is a defect in the Product which is covered by this Limited Warranty, Clarisonic agrees to exchange the Product with a new equivalent Product. This is the sole remedy available for breach of Warranty.
- c) To the greatest extent permitted under applicable laws, this Limited Warranty is exclusive of all other Warranties, whether oral or written, expressed or implied. There are no implied Warranties created by the manufacture, sale, or use of the Product. If Clarisonic cannot lawfully disclaim implied Warranties under this Limited Warranty, all such Warranties, including Warranty of merchantability and fitness for a particular purpose, are limited to the duration of this Limited Warranty. Some countries do not allow limitations on how long an implied Warranty lasts, so this limitation may not apply to you.

2. How to get Warranty service

Contact our customer service department by telephone 1800 838 3388 or visit our website at www.clarisonic.com.sg

3. Limitations

- a) This Warranty is limited and may be relied upon only:

- (i) by the original end user of Clarisonic's Product; and
 - (ii) Where the Product was manufactured by or for Clarisonic and sold by an authorized distributor.
- b) To obtain service under this Limited Warranty, you will be required to provide Clarisonic with original proof of purchase.
 - c) This Limited Warranty does not apply where the Product is subjected to use that does not constitute Normal Use, including but not limited to personal injury or property damage arising from misuse of the Product.

4. Exclusions

Clarisonic is not responsible for any indirect, incidental, special or consequential damages arising out of the use of the Product, whether arising from an electrical issue or otherwise. Some countries do not allow the exclusion or limitation of incidental or consequential damages, so the above limitation or exclusion may not apply to you.

5. Definitions

- a) "**Clarisonic**" means L'Oreal Singapore Pte Ltd (registration no.:199001413D).
- b) "**Normal Use**" means ordinary consumer use under normal home conditions according to the instruction manual included with the Product. It does not include using the Product with a voltage converter.
- c) "**Product**" means **Alpha Fit** or **Mia Fit**.
- d) "**Warranty Period**" means **2 year** from the date of purchase of the Product.

Singapore – 30 day Feel and See Guarantee disclaimer:

We offer a 30 day money back guarantee. The Feel and See Guarantee is valid for a period of 30 days from date of purchase and can only be claimed from the retailer where the device was originally purchased. Proof of purchase is required and the product must be returned in its original packaging with all the components.

PLEASE NOTE: The 30 day Feel and See Guarantee does not apply to Clarisonic devices purchased in the travel retail channel.



Pacific Bioscience Laboratories, Inc.
17275 NE 67th Court,
Redmond, WA 98052 USA

www.clarisonic.com/customerservice

© 2015 Pacific Bioscience Laboratories, Inc.
All rights reserved

Printed in the USA



5000184